

GREEN IN
QUALITY AND SAFETY
BY MARUTI SUZUKI



CELEBRATING
52
YEARS
COMPLETED

TOSHEE INDUSTRIES PVT. LTD.

IF YOU CAN DESIGN, WE CAN MAKE

Since : 1972



IATF Certified Company

Manufacturer of Critical Machined Components in
Brass, Copper, Stainless Steel, Carbon Steel And Plastics

www.toshee.com

MANAGEMENT



Mr. S.K. Garg
(Chairman & Managing Director)



Mr. Manish Garg
(Director & President)



MISSION

"To innovate and provide high-quality technology solutions that empower businesses and individuals across the globe, delivering sustainable growth and positive impact."

VISION

"To be the world's leading provider of sustainable and transformative solutions, connecting communities and industries through cutting-edge innovation and excellence."

Overview & Milestones of Toshee Industries

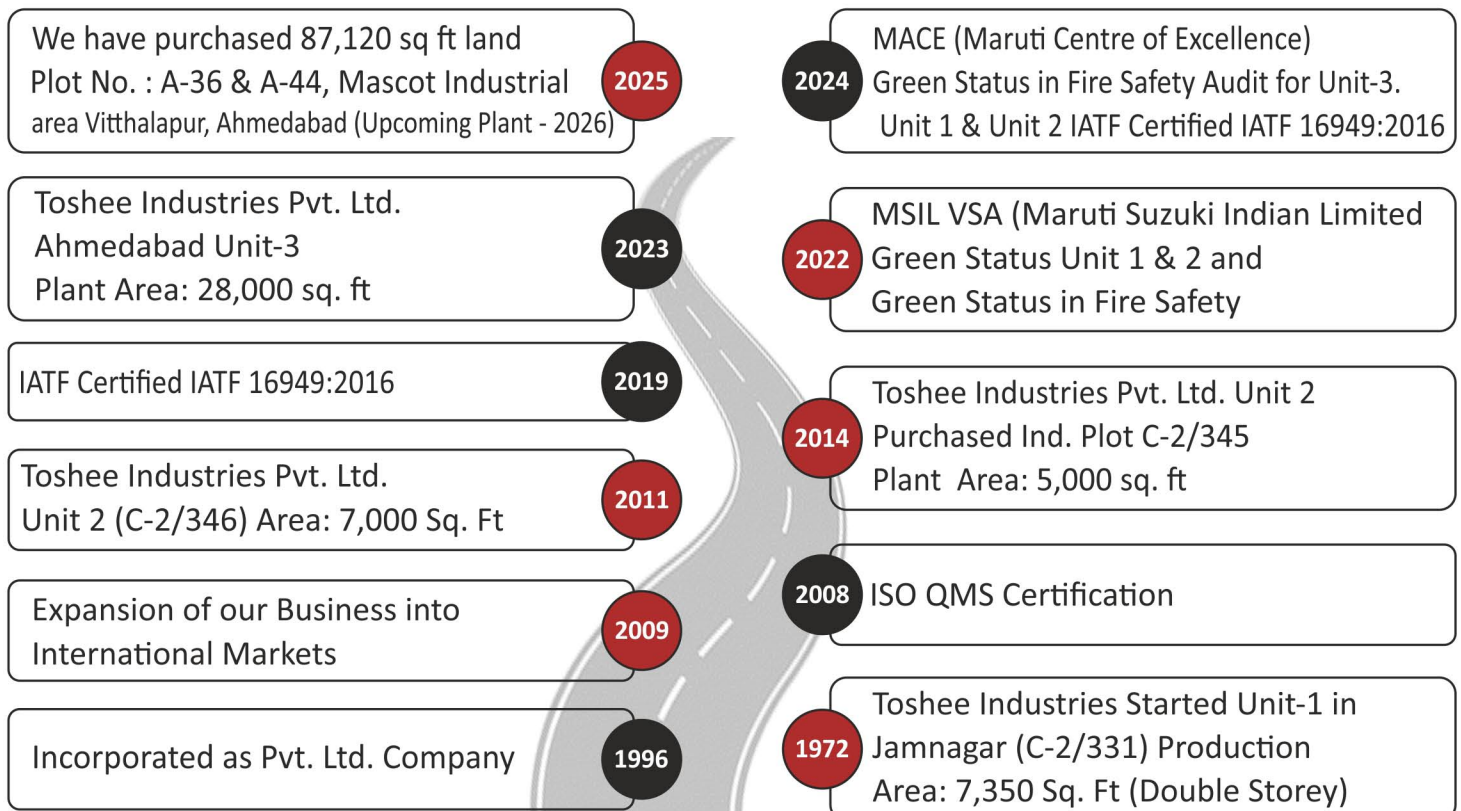



We at Toshee Industries Pvt Ltd are in the business of “Manufacturing of Precision machined Components with Zero PPM at Customer”.

We are committed to satisfy our valued customer through our Products, Services, Timely Delivery, Quality Products by Enhancing Customer Satisfaction.

We will continually improve our product and services through innovation and up-gradation of technology and Quality Management System.

IF YOU CAN DESIGN, WE CAN MAKE

We also develop the competency level of all employees and our External Providers

This will be achieved by:

- ✓ Implementation of Total Quality Management System.
- ✓ Complying with the Statutory, Regulatory and applicable requirements
- ✓ Implementation of competence development programs for employees and external providers.

Direct Customer (Tier – 1)

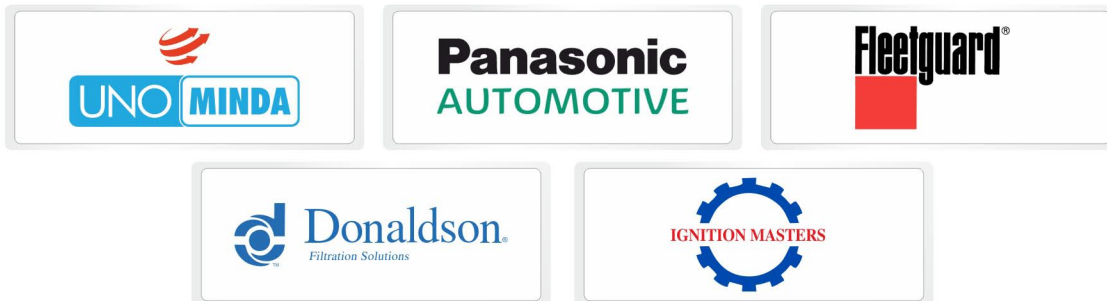

In-Direct OEM (Through Tier – 1)





Raw Material

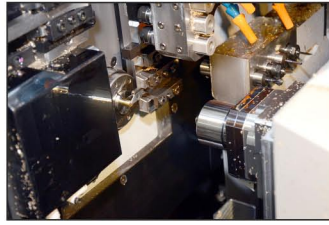

CNC Sliding Head Machining



Traub Machines

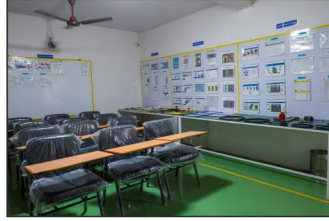

Training Hall



Optical Sorting Machine



Inspection



Contour Measuring Machine



Laser Marking Machine



CNC Sliding Head Machines



CNC Machines



CNC Sliding Head Machines



Optical Sorting Machine

| Sr. No | Type Of Machine | Make | No of Machines |
|--------|--------------------------|-------------------|----------------|
| 1 | Traub Machines | Traub | 50 |
| 2 | CNC Swiss Sliding Head | Tsugami & Citizen | 20 |
| 3 | Drilling Machines | Domestic | 11 |
| 4 | Special Purpose Machines | Domestic | 7 |
| 5 | Threading Machines | Domestic | 30 |
| 6 | Milling Machine | Domestic | 11 |
| 7 | DG 60KV - 1, 125KV - 1 | Mahindra | 2 |

Certificate

Standard **IATF 16949:2016**
(1st edition, 2016-10-01)

Certificate Registr. No. **01 111 2436305**
IATF Certificate No. **0542412**

Certificate Holder: **TOSHEE INDUSTRIES PRIVATE LIMITED**
C-2/331, GIDC, Phase - 1, Udyog Nagar, Shankar Tekri,
Jamnagar - 361004, Gujarat, India

IATF USI: **6ZLWTR**
With extended manufacturing site(s) according to annex
Scope: **Manufacturer of Precision Turned Components.**
Excluding Product Design

Validity: **The certificate is valid from 2024-09-03 until 2027-09-02.**

Release date: **2024-09-05**



2-IAO-QMC 01003

WCC
TÜV Rheinland Cert GmbH
An Graeven Steen 51105 Köln
Germany - NRW

1 / 2

www.tuv.com

TÜV Rheinland
Precisely Right.

Quality Instruments

- ✓ Contour
- ✓ Vision Measuring Machine
- ✓ Roughness Tester
- ✓ Rockwell Hardness Tester
- ✓ Vision Inspection System
- ✓ Optical Gauging & Sorting System
- ✓ Height Gauge

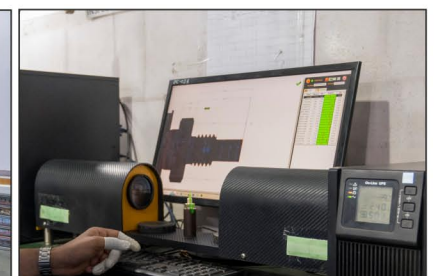
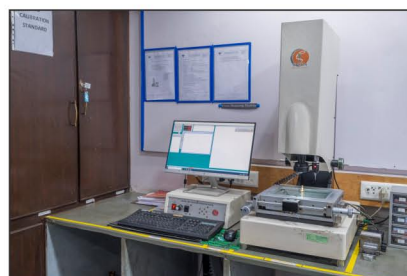

Manufacturing Capability : Ahmedabad



Assembly and Sub Assembly Line



Injection Moulding Machines



Assembly Line



Injection Moulding Machines



PAD Printing Machines



Vertical Injection Molding Machines

| Sr. No | Type Of Machine | Make | No of Machine / Line |
|--------|------------------------------------|-----------|----------------------|
| 1 | Assembly & Sub Assembly Lines | Domestic | 10 |
| 2 | Horizontal Moulding Machine - 80 T | Milacron | 1 |
| 3 | Horizontal Moulding Machine - 50 T | Milacron | 2 |
| 4 | Vertical Moulding Machine - 40 T | All Plast | 1 |
| 5 | Pad Printing Machines | Spinks | 4 |
| 6 | Compressor Set 125 CFM | Domestic | 1 |
| 7 | Diesel Generator Set 125 KV - 1 | Domestic | 1 |
| 8 | Ultrasonic Cleaning Machine | Domestic | 1 |
| 9 | Descaling Machine | Domestic | 1 |
| 10 | Mould Temperature Controller | Domestic | 4 |

Quality Instruments – Ahmedabad

Standard Room



- ✓ Superior Measurement accuracy & repeatability for tight tolerance application.

| Sr. No | Type Of Instruments | Make | No of Instruments |
|--------|-----------------------------------|-----------------------|-------------------|
| 1 | Vision Measurement System | Customised Technology | 01 |
| 2 | Digital Height Gauge 0-300 mm | Baker | 01 |
| 3 | Digital Push Pull Gauge 0-50 Kg | Insize | 01 |
| 4 | Digital Vernier Calliper 0-300 mm | Baker | 02 |
| 5 | Digital Vernier Calliper 0-150 mm | Baker | 06 |
| 6 | Digimatic Micro Meter 0-25 mm | Mitutoyo | 02 |
| 7 | Digimatic Indicator 0-50 mm | Mitutoyo | 01 |
| 8 | Slip Gauge Set 0.05-100 mm | Insize | 01 |
| 9 | Pin Gauge Set 0.5 -6.0 mm | Baker | 01 Set |
| 10 | Digital Lux Meter | Domestic | 01 |
| 11 | Granite Surface Plate 630X630 mm | Domestic | 01 |
| 12 | Weighing Scale 0-1000g | Domestic | 01 |

Automotive Components



Automobile Thermal Temperature Sensors



Automotive Parts: Brass, Copper



OUR PRODUCTS

Stainless Steel Parts

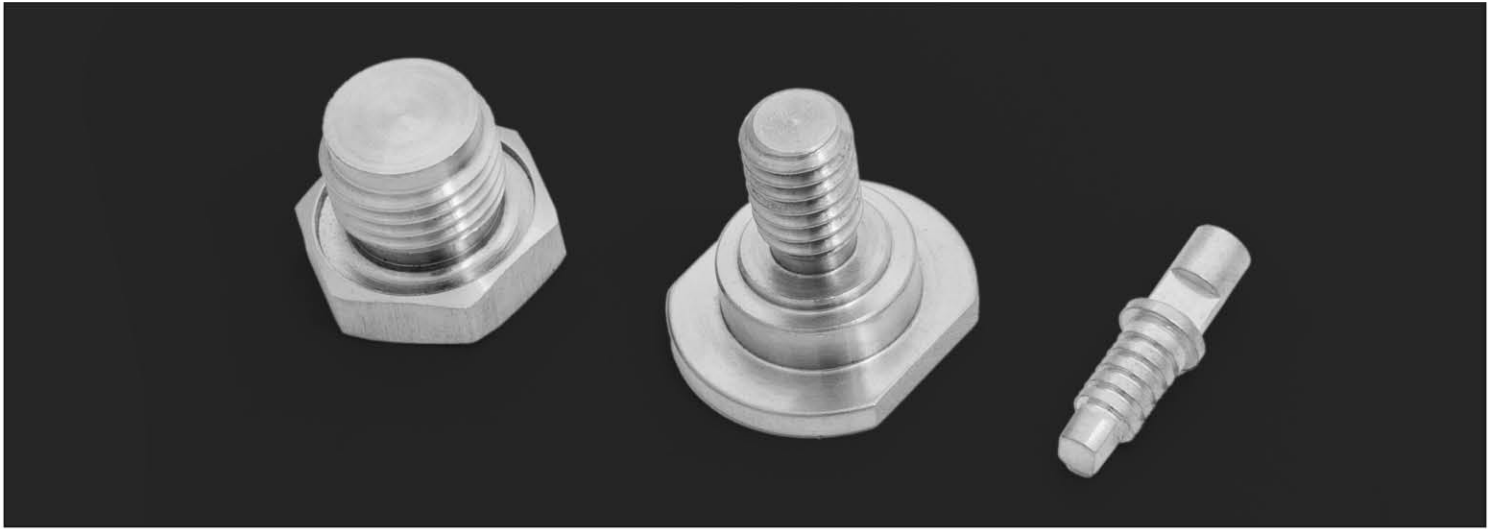

Copper Silver Plated Parts



Assembly of Plastic & Press Components



Pad Printing





Jamnagar Plant Address : (Total Area : 17,000 Sq.ft.)
C2/331,345,346, GIDC, Phase 1, Udyog Nagar,
Shankar Tekri, Jamnagar- 361004, Gujarat, India
+91 288 2560592 / 2563088

(Upcoming Plant - 2026)
Mascot Industrial City
Plot No. : A-36 & A-44,
Opp. Madal Bechraji SIR TP - 5.
Nr. Jetro Park, Vitthalpur,
Ahmedabad - 382120, Gujarat, INDIA



Ahmedabad Plant Address : (Total Area : 28,000 Sq.ft.)
Plot no E31 & 32, Mascot Industrial Park,
Jadavpur Cross Road, Kadi Vitthalpur Highway,
Kadi Mehasana- 384440, Ahmedabad, Gujarat, India



TOSHEE INDUSTRIES PVT. LTD.

Corporate Office Address :

Office no 301 & 302 , Platinum Building ,
Above Swift Mart, Near Joggers Park,
Jamnagar – 361008,
Gujarat, INDIA

Phone & Email :

+91 63565 60303
info@toshee.com
+91 82385 65355
marketing@toshee.com



www.toshee.com